

EXTRA! EXTRA!

Port Saint Lucie Mayor Declares: “ALL RESIDENTS MUST EVACUATE IMMEDIATELY!”

An unlikely turn of events took place today as the Mayor of Port Saint Lucie declared that ALL residents must evacuate the town as soon as possible!

Recent studies have shown that toxic levels of radiation have been leaking from the local power plant for quite some time now. Residents are in extreme danger of getting sick from the radiation. Many people are calling this unfortunate situation a repeat of *Chernobyl*.

Stunned residents with no where to turn have begun to look for alternative places to live. For many with no family to take them in and no where to go, the situation could not be any worse.

But where to go and what to do? Government agencies are encouraging residents to relocate west of St Lucie County into a home that will cause no further damage to our fragile environment. Local, state and national governments are working together to help relocate residents as soon as possible. They are even offering to help with the cost of getting a new home as long as residents agree to move in to *sustainable*, solar house which is made of natural and recycled materials otherwise known as *Earthships*.

All residents are urged to come to the town hall meeting to meet with several construction companies with extensive experience building these types of

homes. For further information please see the attached information sheet.



Sustainable Earthship made of old tires and mud

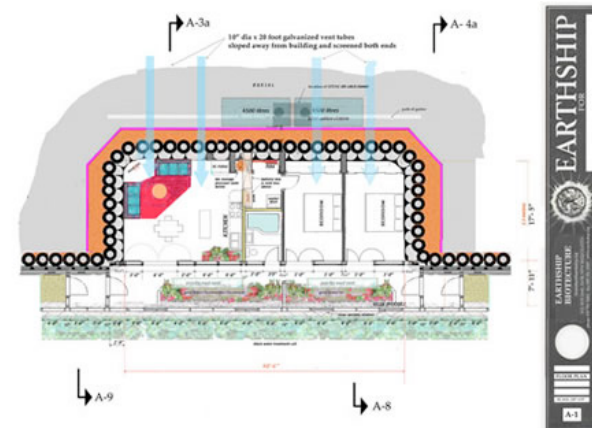

LOCAL RESIDENTS RESPOND TO THE SHOCKING NEWS

“I can’t believe this is happening! I mean...I grew up here! The thought of being forced to leave is too much to bear. What if I never see my friends again? What will my life be like and what in the world is this crazy Earthship idea?!”

- Samantha C, 13, PSL student

“I don’t know...I think it might be kinda cool. I like the idea of building something that will not hurt the environment. Plus from what I understand, these houses are totally self sufficient, so you need very little from the outside world. If anything like this ever happens again, we will be all set!”

- Laura S. PSL teacher

Earthship Factsheet

Everything you need to know about your new home

- ✓ Constructed of mostly recycled materials like automobile tires, glass bottles, aluminum soda cans, etc
- ✓ Earthships catch water from the sky and re-use it up to four times to flush toilets and feed indoor gardens and outdoor landscaping
- ✓ Water is heated by solar or natural gas sources, however public water can be tapped for a backup source
- ✓ Earthships contain and treat all household sewage in indoor and outdoor botanical cells that feed food gardens and landscaping
- ✓ Indoor "wetlands" provide balanced humidity and a constant supply of fresh air
- ✓ Electricity can be produced naturally from solar and wind sources
- ✓ Earthships use the sun to maintain comfortable temperatures year round in any climate
- ✓ Many successful earthship communities already exist in areas like New Mexico and Arizona
- ✓ Food, plants and even trees can be grown inside
- ✓ Inner walls can be built using dirt, sand, chopped straw and other natural materials that are formed into a natural plaster material that is as structurally sound as concrete
- ✓ Outer walls are composed of old tires filled with natural earth which helps to keep it cool in the summer and warm in the winter
- ✓ Earthships are generally built into the side of a hill or bank with one window filled side facing the sun
- ✓ Side walls can be constructed of glass bottles or other translucent materials

Your Task.....

Please read all instructions carefully. If you have any questions please contact Mrs. Stebbing, your local building advisor in Room 201

Stage 1: Research.

- Complete extensive research on the negative effects humans are having on our environment. Take detailed notes of the following:
 - What are the most important environment issues that we are facing today
 - What issues can be fixed if we can change the way we live
 - Include statistics and data to support your findings
- Complete extensive research on the Earthship concept. Take detailed notes of the following:
 - How they work
 - How they are constructed
 - How long they take to build
 - Cost and materials needed
 - Earthship communities which already exist
 - Best locations
 - Where/How to get food and supplies
 - Why is an Earthship good for the environment
 - What is life like when you live in an Earthship
 - Drawings, blueprints or floorplans
 - Anything else that you feel is important

Stage 2: Create Your Plan

- Lucky you! You are NOT one of the families that has to move. You are an architect for a company that builds Earthship homes. Your task is to design the BEST Earthship plan and sell it to the families that need to move. What makes your Earthship better than the others? The company that sells the most homes wins the challenge!
- You will need to:
 - Choose a partner and create a company name

Your Task.....

- Use your research to develop an in-depth drawing, blueprint or floorplan which shows everything your model has to offer. What makes your model better than your competition?
- Name your model and come up with a reasonable selling price
- Create a brochure which highlights everything that your Earthship model has to offer. Include your drawing or floorplan showing all details (see examples below)
- Create a poster which advertises your Earthship. Your poster should be designed to SELL your model, Make it catchy and interesting!

Stage 3: Presentations and Voting

- Lastly, you and your partner will present your Earthship idea to the class. Be sure to SELL it to the group as the BEST choice!
- The class will vote on the Earthship they feel is the best.

Grading

You will be graded on your research, brochure, poster and presentation.

This is a PROJECT BASED LEARNING assignment. That means that you are learning throughout the process of completing the project. You should be learning TONS about renewable/sustainable resources, human impact on the environment, environmental issues, alternative ways of living, etc. You must show motivation, discipline and maturity to get the work done with a minimal amount of guidance. However, should you need help please see me during lunch OR email me: lstebbing@stluciecharter.org

Due Dates

Research:

Brochure:

Poster:

Presentation:

Our Research

(include the names of any websites you used)

Our Research

(include the names of any websites you used)

